

PROGRAMMABLE

UNIVERSAL TPMS SENSOR



Angle Adjustable 1-Sensor Metal/Rubber Valve (Screw-in)

⚠ CAUTION:

CGSULIT UNV -sensor arrive blank and can be programmed with CGSULIT TPMS80 or other authorized TPMS programming tool, which is recommended to program prior to installation. Do not race with the vehicle on which the Clamp -in UNV -sensor is mounted, and always keep the drive speed under 240km/h.

INSTALLATION GUIDE

⚠ **IMPORTANT:** Before operating or maintaining this unit, please read these instructions carefully and pay extra attention to the safety warnings and precautions. Use this unit correctly and with care. Failure to do so may cause damage and/or personal injury and will void the warranty.

1 Loosening the tire

Remove the valve cap and core and deflate the tire.
Use the bead loosener to unseat the tire bead.

⚠ **CAUTION:** The bead loosener must be facing the valve.

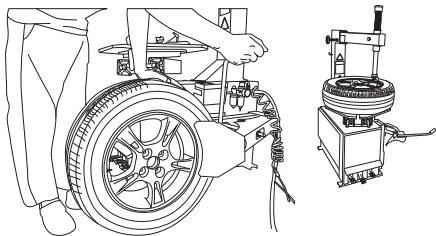

SAFETY INSTRUCTIONS



Before installing the sensor, read the installation and safety instructions carefully. For reasons of safety and for optimal operation, we recommend that any maintenance and repair work be carried out by trained experts only, in accordance with the guidelines of the vehicle manufacturer. The valves are safety-relevant parts which are intended for professional installation only. Failure to do so may result in the failure of the TPMS sensor. CGSULIT does not assume any liability in case of faulty or incorrect installation of the product.

⚠ CAUTION

The TPMS sensor assemblies are replacement or maintenance parts for vehicles with factory installed TPMS. Make sure to program the sensors by CGSULIT sensor programming tools by the specific vehicle make, model and year before installation. Do not install programmed TPMS sensors in damaged wheels. In order to guarantee optimal function, the sensors may only be installed with original valves and accessories provided by CGSULIT. Upon completing the installation, test the vehicle's TPMS following the procedures described in the original manufacturer's user guide to confirm proper installation.

2 Dismounting the tire

Clamp the tire onto the tire changer, and adjust the valve at 1 o'clock relative to the tire separation head. Insert the tire tool and lift the tire bead onto the mounting head to dismount the bead.

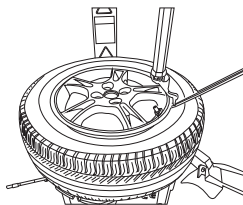

⚠ CAUTION:

This starting position must be observed during the whole dismounting process.

3 Dismounting the sensor

Remove the screw nut from the valve stem, and then remove the sensor assembly from the rim.

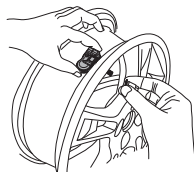

WARRANTY

CGSULIT guarantees that the sensor is free from material and manufacturing defects for a period of twenty-four (24) months or for 24,000 miles, whichever comes first. CGSULIT will at its discretion replace any merchandise during the warranty period. The warranty shall be void if any of the following occurs:

1. Improper installation of products
2. Improper usage
3. Induction of defect by other products
4. Mishandling of products
5. Incorrect application
6. Damage due to collision or tire failure
7. Damage due to racing or competition
8. Exceeding specific limits of the product

CAUTION: Each time a tire is serviced or dismounted, or if the sensor is removed or replaced, it is mandatory to replace the rubber grommet, screw nut and valve core with our parts to ensure proper sealing. It is mandatory to replace the sensor if it is externally damaged. Correct sensor nut torque: 4.0 Nm.

4 Mounting sensor and valve

- Step1. Connect the sensor body and valve stem at a suitable angle(Normally use the maximum angle of 30°) and tighten the screw.
- Step2. Remove the screw nut from the valve stem.
- Step3. Slide the valve stem through the valve hole of the rim with the sensor on the inside of the rim.
- Step4. Assemble the screw nut back on the valve stem with 4.0 Nm power, then tighten the cap.

CAUTION: 30° is suitable for most rims. If the angle does not match the rim while installing in step 3, please loosen the screw then re-operate from step 1.

Step 1

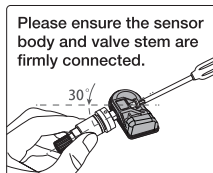

Step 2

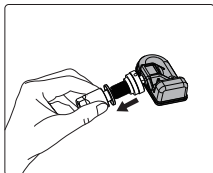

EXPLODED VIEW OF SENSOR

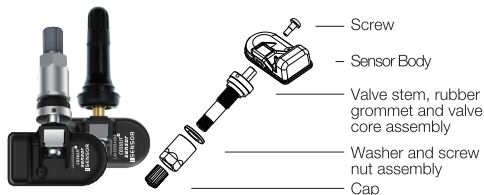

Technical data of the sensor

Weight of sensor without valve	13g
Dimensions (excl. valve's size)	approx. 44.6*28.3*16mm
Max. pressure range	800kPa

Step 3

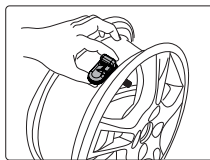

Step 4

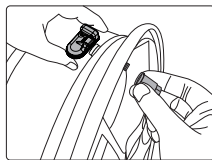

5 Mounting the tire

Place the tire on the rim, make sure that the valve faces the separation head at an angle of 180°. Mount the tire over the rim.

CAUTION: The tire should be mounted to the wheel using tire changer manufacturer's instructions.

